

STEPPER MOTOR

Stepper motor 3-phase 325 V DC Used together with VariMax50 CE

F22050501

VariMax-motor50 CE



- Adapted for variable speed control
- Built-in thermal contact, drawn to terminal
- Compact built-in dimensions
- CE-approved
- Five-year product warranty

DIMENSIONS

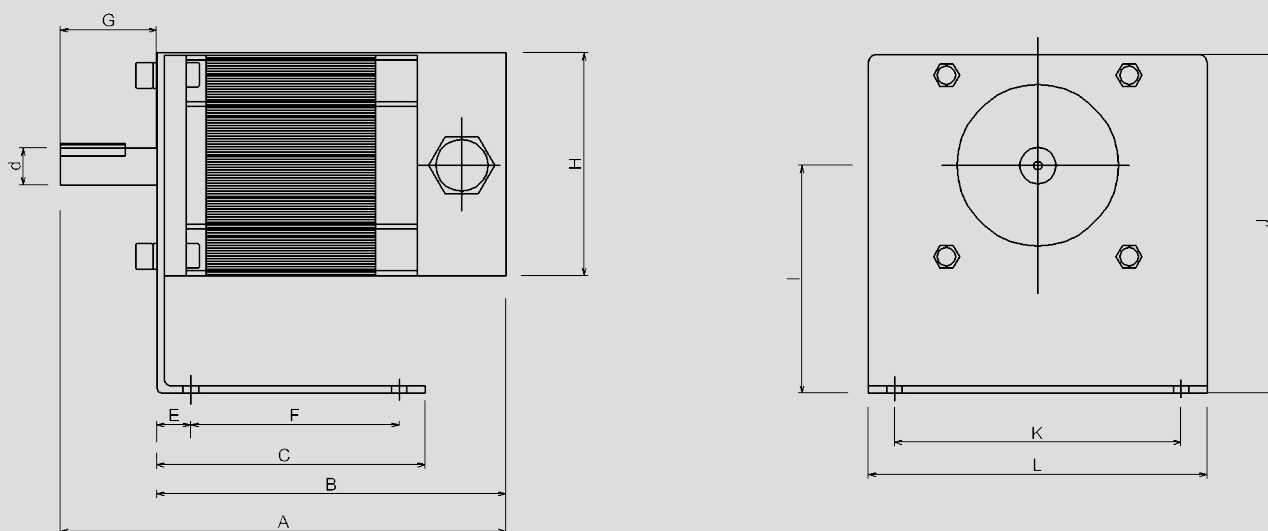

Construction dimensions (mm)

| MOTOR | A | B | C | d | E | F | G | H | I | J | K | L |
|-------|-----|-----|-----|----|----|----|----|----|----|-----|-----|-----|
| 50 | 171 | 131 | 103 | 14 | 13 | 80 | 40 | 85 | 87 | 130 | 110 | 130 |

Technical data

| VariMax-motor CE | 50 |
|----------------------------|---------------------------------|
| Max torque | 4 Nm |
| Min rotation speed | 1 rpm |
| Max rotation speed | 375 rpm |
| Motor temp. mantle max | 110 °C |
| Ambient temperature | -30 - +45 °C -40 - +45 °C *) |
| Protection form | IP54 |
| Weight incl. motor bracket | 4 kg |

*) Note, at -40 °C, the control unit must be connected to power all the time

Max rotor diameter at rotor speed 12 rpm

| Motor | 50 |
|----------------|---------|
| Rotor diameter | 2500 mm |