

MOTOR 1-PHASE

In line helical gear motors with tachometer feedback 1x230 V, 50 Hz

F22040101

40/100



- Adapted for voltage regulation
- Built-in thermal contact, not drawn to terminal
- Compact built-in dimensions
- Two-year product warranty

DIMENSIONS

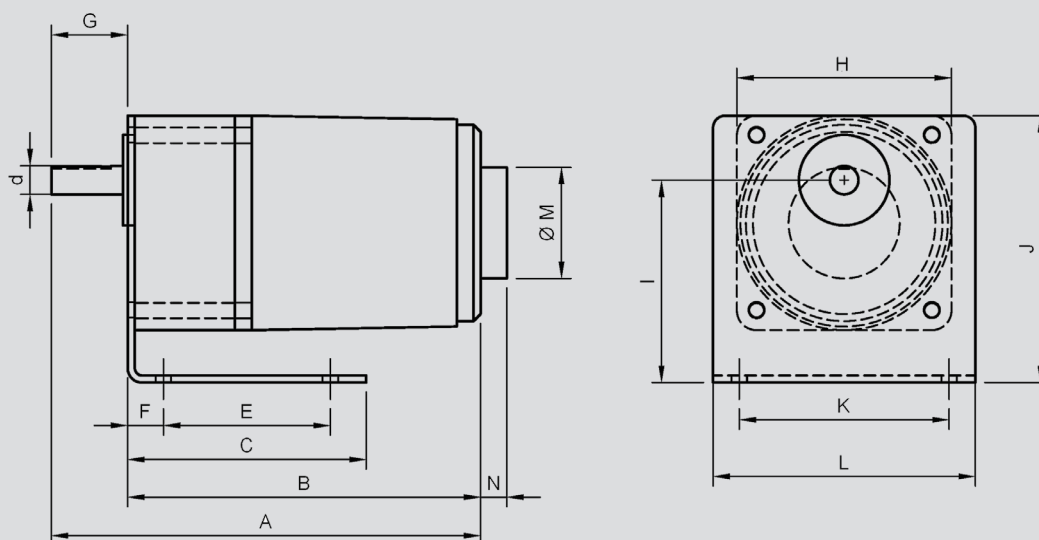

Construction dimensions (mm)

MOTOR	A	B	C	d	E	F	G	H	I	J	K	L	M	N
40/100	180	150	100	12	80	15	32	90	85	110	88	110	47	11

Technical data at 50 Hz

Motor	40/100
Rated output	40 W
Rated current at 230 V	0,49 A
Rated speed	100 rpm
Gear ratio	1:12,5
Rated torque	4 Nm
Protection form	IP20
Connection voltage	1x230 V
Weight including motor bracket	3,7 kg
Motor capacitor	2,0 uF

Max rotor diameter at rotor speed 12 rpm

Drivmotor	40/100
Rotordiameter	1050 mm

Other data

Tachometer feedback is 0-24 V DC.